



**Flat 7, 2 Wellesley terrace London N1 7NA – 2-bedroom shared ownership apartment only
£279,000**



**Flat 7, 2 Wellesley terrace London N1
7NA**

Full market value: £620,000

45 % equity: £279,000

Monthly rent: £509.16

Monthly service charge: £124.12

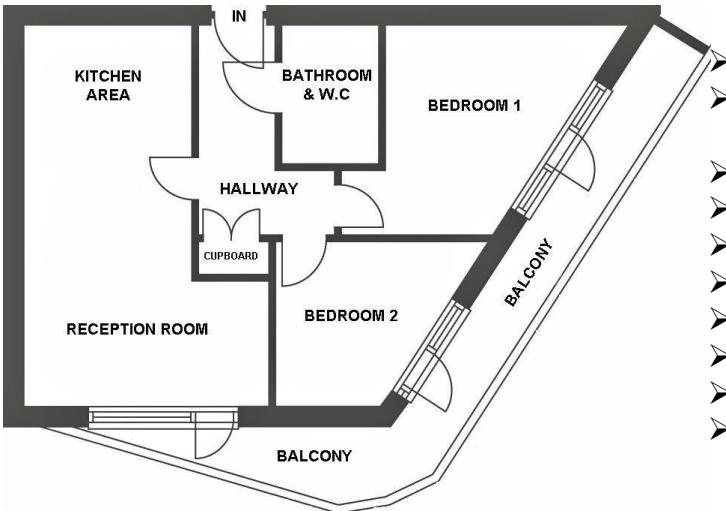

- L-Shaped entrance hallway & built in cupboard
- L-Shaped reception room & open plan Kitchen
- 2 Bedrooms
- Bathroom & W.C.
- Gas central heating
- Engineered wood flooring to living/dining areas
- Carpet in bedrooms
- Recessed Balcony to South & West elevations
-
- Communal roof garden

To arrange a viewing appointment please register on line at www.isha.co.uk
Viewing is strictly by appointment only

These brief particulars are intended as guide to supplement an inspection or survey and do not form part of any offer or contract. Their accuracy cannot be guaranteed. They contain statements of opinion and in some instances we have relied upon information supplied by others. You should verify the particulars by visiting the property. These particulars do not obviate the need for a survey and all appropriate enquiries. Accordingly there shall be no liability as result of any error or omission in the particulars or any information given. All information believed to be correct at time of publication. June 2016.